

Electrical Diagram

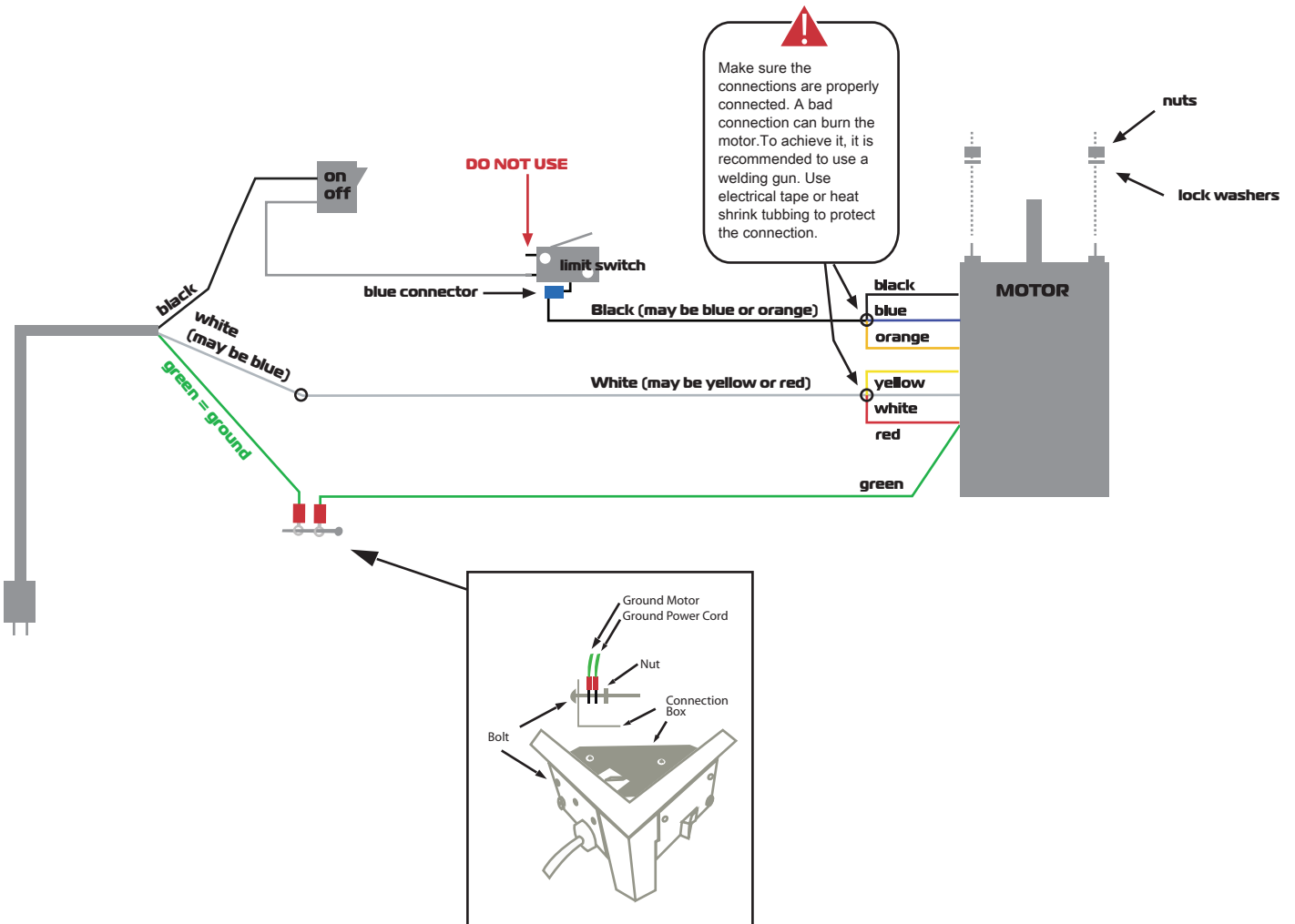

North America (110V)

www.trimpro.ca





MOTOR REPLACEMENT : STEP BY STEP.

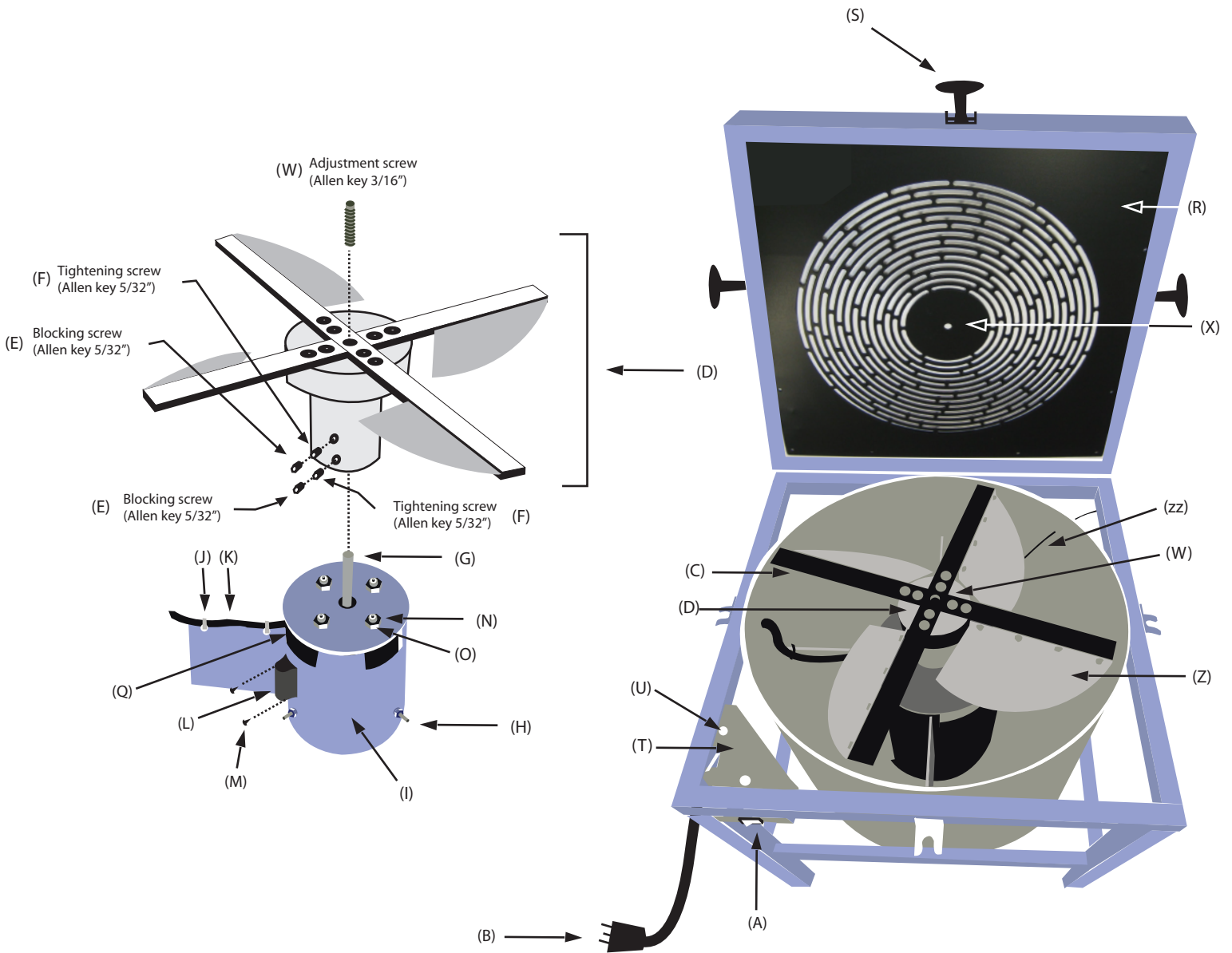

MOTOR REPLACEMENT : STEP BY STEP

1

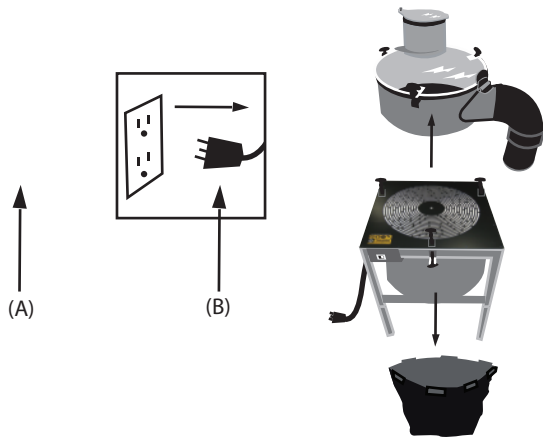

Turn OFF the machine with the ON-OFF switch (A) and unplug the power cord (B) from the electrical outlet. Remove the bag using the Velcro strips on top of it and remove the circular aluminium & plastic structure using the rubber fasteners.

2

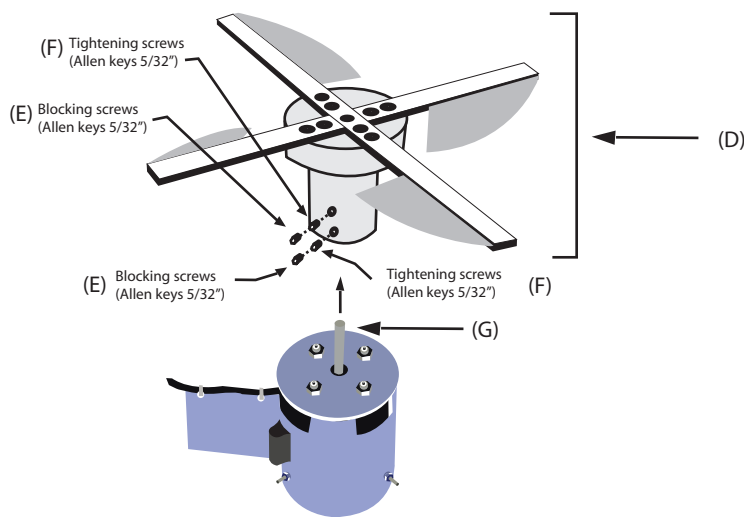

Remove the blade assembly (blade + tubular structure under it) later referred as the blade-hub (D). To achieve it, remove the 2 blocking screws (E) from the blade-hub and unscrew the 2 tightening screws (F). To remove the whole blade and blade-hub, raise it from the motor shaft.

3

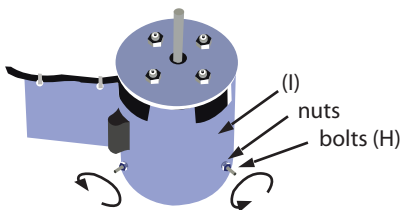

Unscrew the 3 nuts and then the 3 bolts (H) on the side of the structure which hold the motor (later referred as the motor-hub) (I).

4

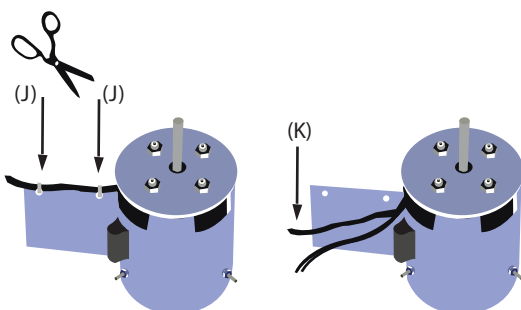

Cut the plastic fastening (Tyrap) (J) and remove the electrical wiring from the black protecting tube (K).

5

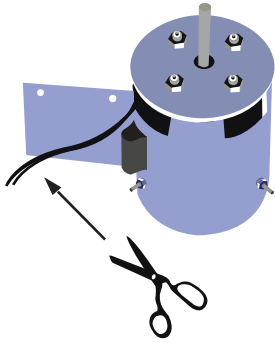

Cut the actual electrical wiring connections with a scissor.

6

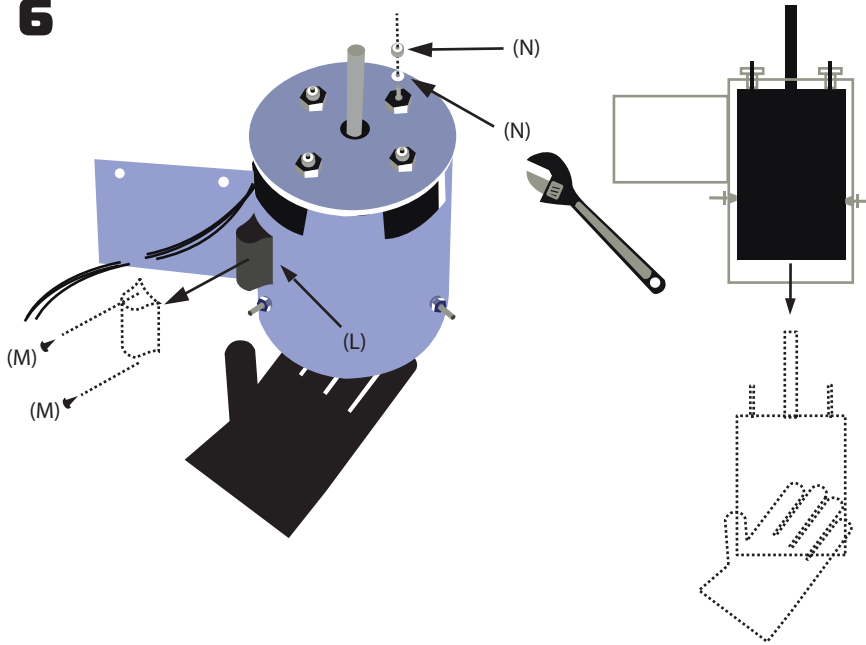

Unscrew the capacitor (L) using the 2 screws (M). Unplug the capacitor's electrical wiring. Hold the motor base (under the motor-hub) and remove the 4 nuts and 4 lock washers (N) that are fixed to the motor rods. Remove the motor.

7

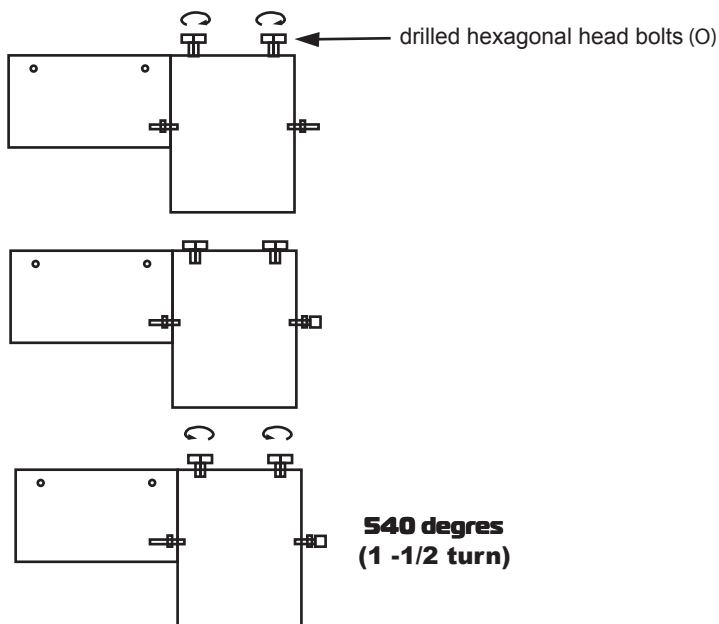

Tighten the 4 drilled hexagonal head bolts (O) to the maximum and then unscrew them one and a half turn.

8

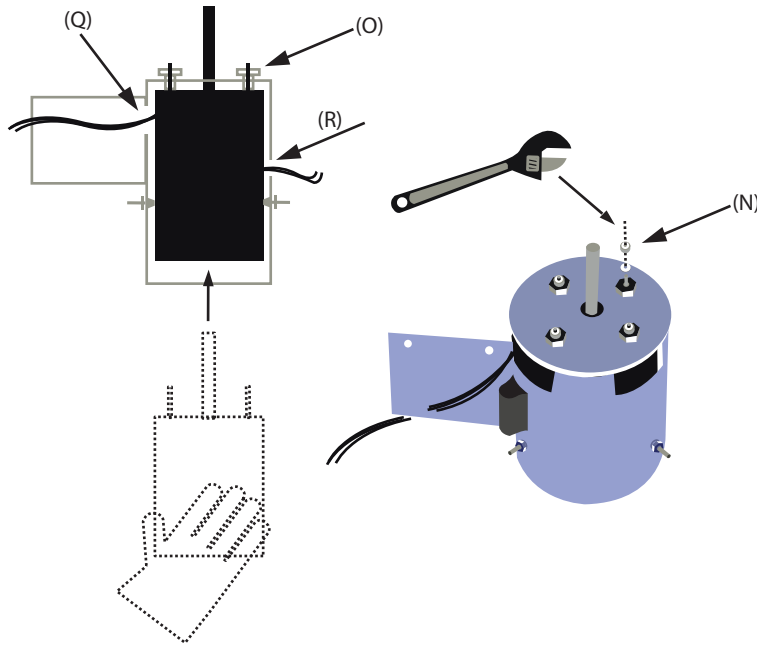

Install the new motor placing the wires on the opening situated on the side of the motor-hub (Q) and pass the capacitor wires through the hole situated on the side of the motor-hub (R).

Place the motor rods inside the drilled bolts (O) (like the old motor).

To fix the motor, push it up to the maximum in the motor-hub structure and then reinstall by tightening the 4 nuts and 4 lock washers (N) on top of the motor-hub.

9

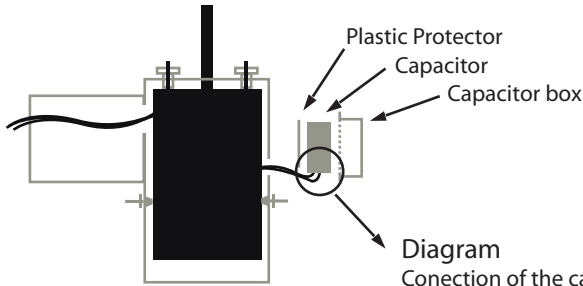
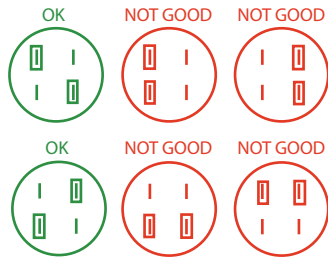
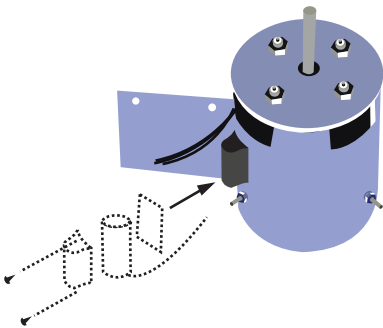
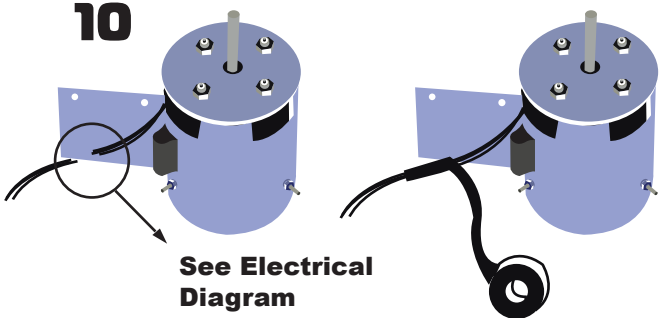

Diagram
Conection of the capacitor wires
The connectors must be connected in diagonal.

Plug the capacitor wires like the old connection (see diagram below) and reinstall the capacitor to the motor-hub structure. Don't forget to insert the plastic protector in between the capacitor and the motor-hub wall.



10



See Electrical Diagram

Make the electrical wiring connections like the old motor (see "Electrical Diagram" at the beginning of this document). It is highly recommended to weld the connections with a welding gun (not supplied). A bad connection can burn the motor.

Then, protect the connections with electrical tape (not included).

Beware! To be sure the machine is secure, you must pay a special attention to the ground connection. See the electrical diagram to know how to plug it adequately.

11

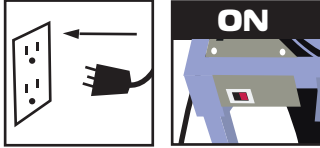

Plug the machine to the electrical outlet and switch ON the machine with the On-Off switch (A).

12 Check if electricity goes to the motor

12.1: Close the lid

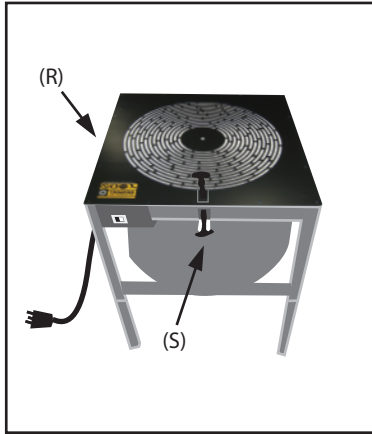

12.2: Is the motor turning?

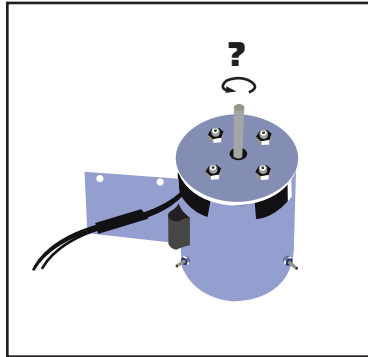

Close the lid of the machine (R) using the rubber fasteners (S) and check if the electricity arrives to the motor (if the motor shaft is turning). If everything works correctly, turn OFF the machine with the On-Off switch (A) and unplug the machine from the electrical outlet. Place the wires in the black protecting tube (K) and fix this tube to the machine with the plastic fastening (Tyrap) supplied with the motor.

If the motor is not turning, go to step # 13.

YES

NO

(See next page)

12.3: Off + Unplug

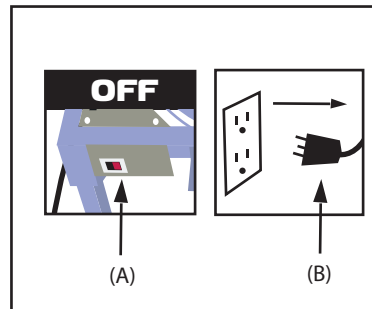

12.4: Replace wiring.

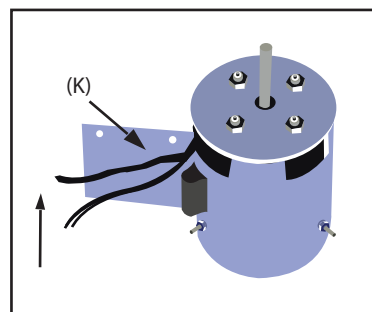

12.5: Fix the protecting tube.

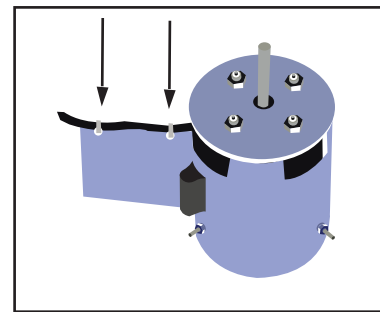

13 If the motor is not turning while the machine is On.

13.1: Close the lid (see 12.1 previous page)

If the machine does not work properly even if it is turned ON, check the electricity wall plug. If this is not the problem either, open the connection box (T) with the 4 screws (U) on top and side of the connection box to check if the wires and connectors are all correctly connected. Once the connections are verified, put back the connecting box together and test the machine again. If everything is back to normal, place the wires back in the black protecting tube (K) and fix this tube to the machine with the plastic fastening (Tyrap) supplied with the motor.

If it doesn't work, contact Trimpro.

13.2 : Is the motor turning?

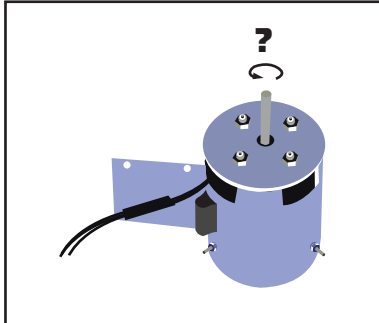

NON

13.3 : Is the electricity working?

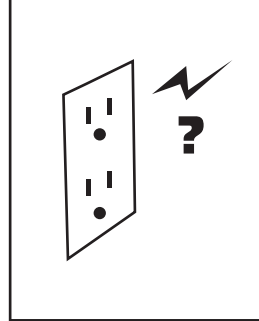

YES

NO

Arrange the electrical system.

13.4 : Open connection box. Is the wiring well connected?

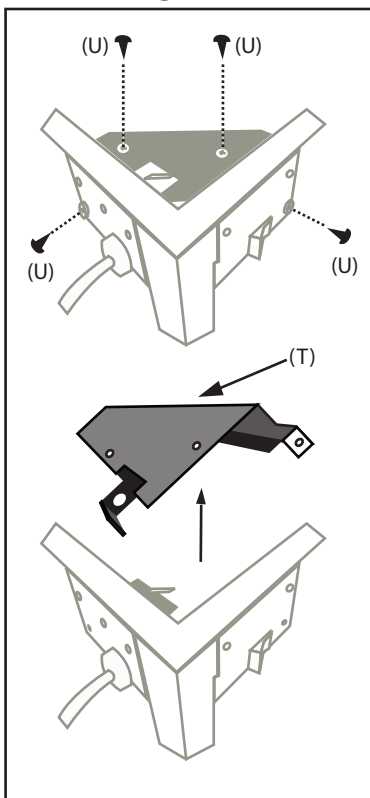

NO

13.5 : Fix the connections.

13.6 : Is the motor turning?

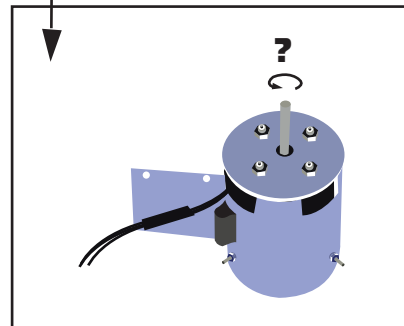

YES

See steps
12.3, 12.4, 12.5
previous page.

NO

Contact
TRIMPRO:

info@trimpro.ca
T. 450 349 0811

YES

14

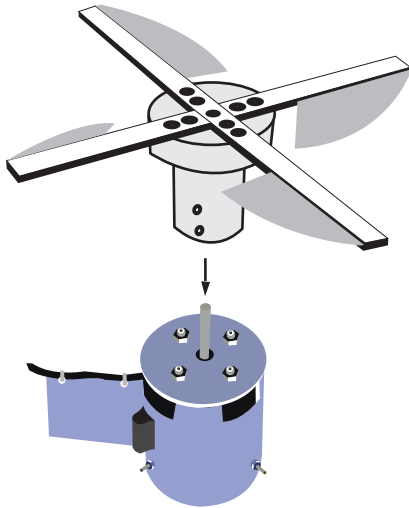

Reinstall the blade and blade-hub on the machine in one piece without tightening the tightening screw.

15

Close the machine's lid (R) using the rubber fasteners (S) (check if the frame that holds the grate is closed evenly over all its surface) and place the blade to its higher position close to the grate (making sure it is not touching the grate) using the height adjustment screw on the center of the blade (W). A hole on the center of the grate (X) gives access to this adjustment screw even of the grate is closed. To raise the blade, use the 3/16" Allen key supplied with the machine and turn clockwise.

15.1: Close the lid.

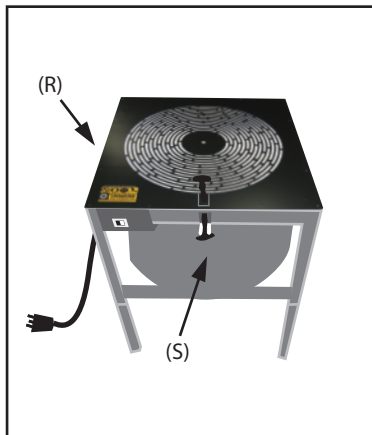

15.2: Place the blade at its highest position (without touching the grate).

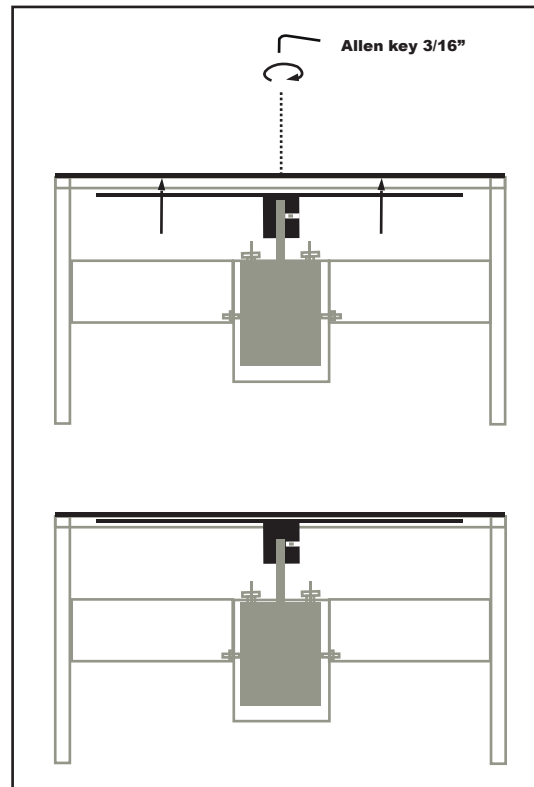

Accès à la vis d'ajustement

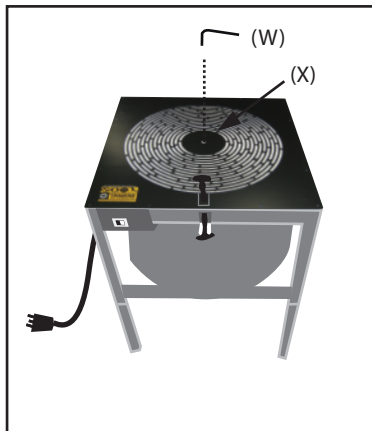

16 Level out the distance

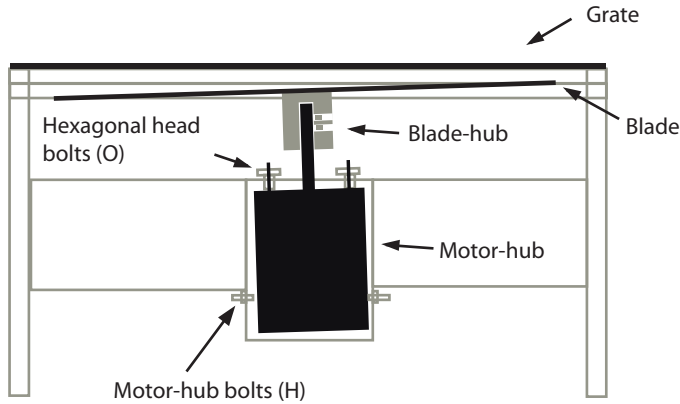

Check if the blade is at equal distance to the grate from each of its extremities (Y1 & Y2).

If YES, tighten the 3 bolts (H) on the side of the motor-hub until they touch the motor. These bolts should not, however, exert any pressure on the motor. Tighten the nuts that are on the bolts.

If NOT, use the four hexagonal head bolts (O) on the top of the motor-hub to level out the distance between the blade and the grate (Y1 & Y2). To raise one side of the blade, turn clockwise the bolt opposite to the side of the blade to be raised (see diagram opposite).

TO RAISE ONE SIDE OF THE BLADE, TURN CLOCKWISE THE BOLT ON THE OPPOSITE SIDE OF THE SIDE TO BE RAISED.

This levelling has to be done with the blade in two positions: X and Y (see diagram "Levelling in two positions" below) until obtaining a uniform distance between blade and grate.

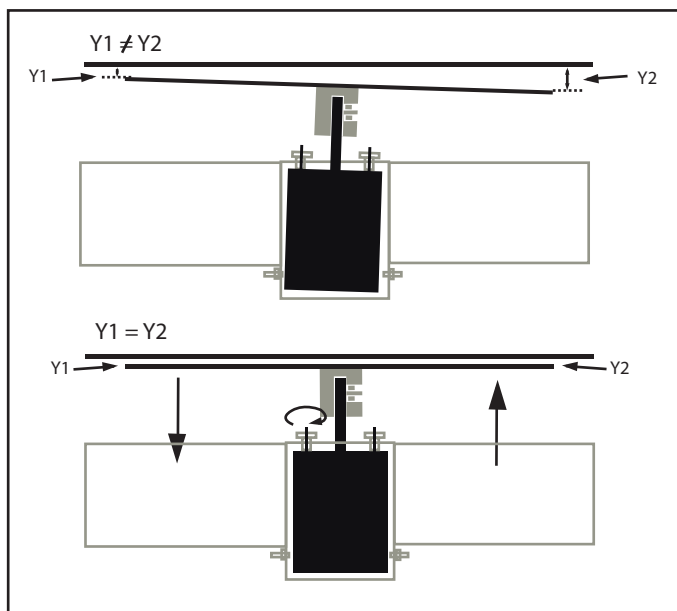
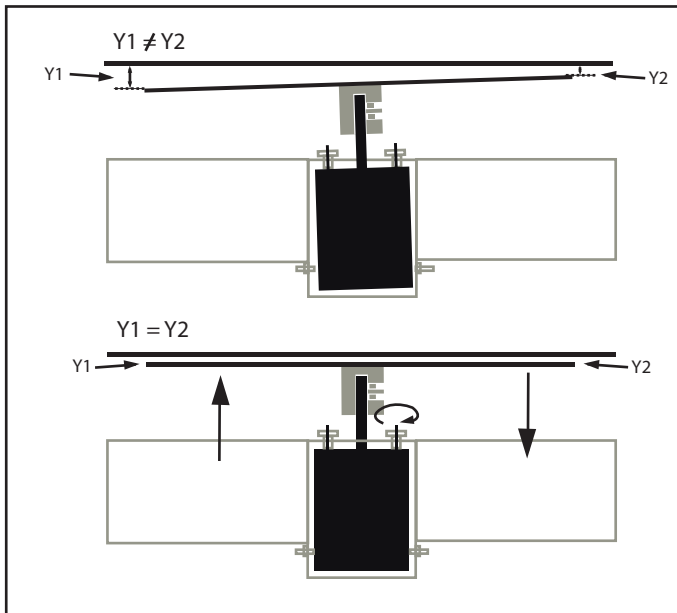

Levelling in two positions.

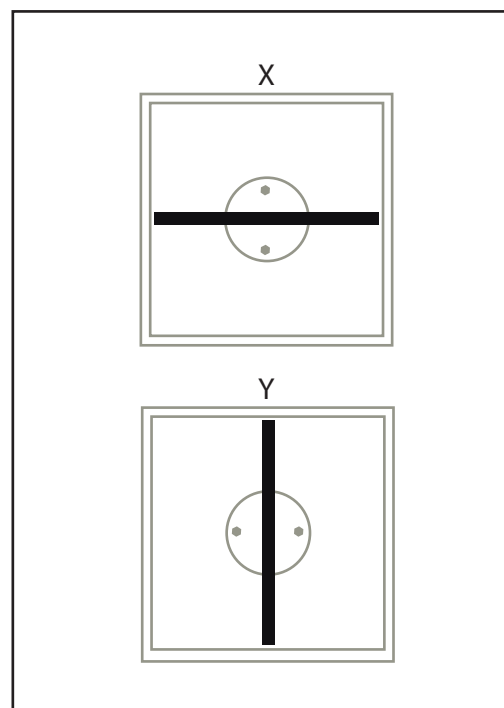

17

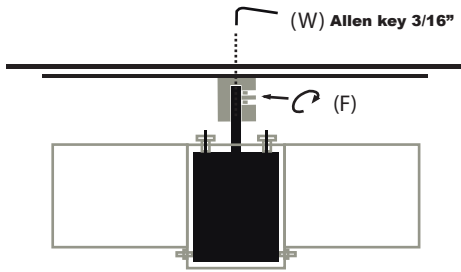

Once the blade is levelled out in relation to the grate, adjust the definitive height of the blade with the height adjustment screw (W). For security reason, a distance of at least 1/8 of an inch (3mm) between the grate and the blade is recommended. Tighten the tightening screw (F).

18

18.1: Plug + ON

Plug the machine to the power outlet, switch ON the machine and make sure the blade never touch the grate or the flaps (Z) never touch the brake's cable (zz) when the machine is running. If everything is OK, reinstall the blocking screw (E).

and tighten the screw. Test the machine again.

If the flaps rub to the brake's cable, change slightly the angle of the flaps, bending them upward manually (see diagram "Side view" below).

If the blade rubs against the grate or if it is too far from the grate, loosen the tightening screw (F), adjust the height

* Caution, the flaps are the ones creating the suction of the machine. If they are too raised, there will be no more suction.

18.2: Close the lid.



18.3: Are the flaps rubbing against the brake's cable?

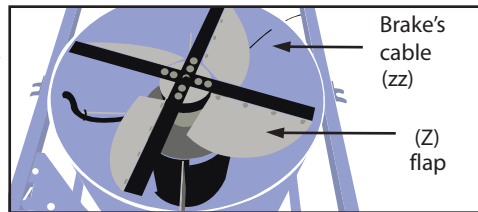

Change manually the angle of the flaps if necessary.

SIDE VIEW



18.4: Is the blade rubbing against the grate?

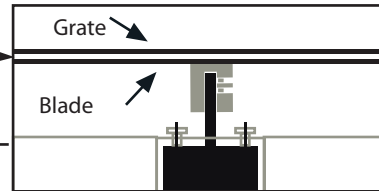

18.5: Loosen, adjust and tighten.

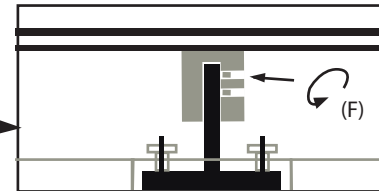

See step #19.

19

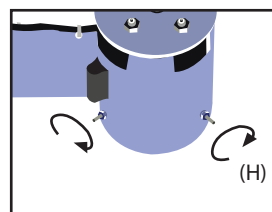
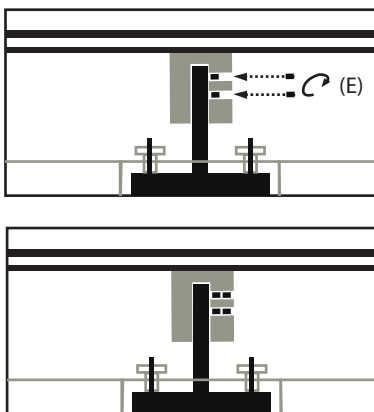

Once the optimal height is achieved, reinstall the blocking screw (E) to fix the blade (C) and the blade-hub (D) (in one piece) over the motor shaft. Tighten smoothly the motor-hub bolts (H) until they touch the surface. (Beware! Too much pressure on the motor can damage it). Tighten the motor-hub nuts. Test again. If everything is OK, you can use the machine.

If not, unscrew the motor-hub nuts and bolts (H) remove the blocking screws (E) and untighten the tightening screws (F) and go back to step # 15.